



# PROPOSALS FOR LAND EAST OF HORNDEAN

## LANDSCAPE AND MOVEMENT FRAMEWORK

By responding to the existing landscape features, the proposals offer the opportunity to create a coherent and continuous landscape strategy throughout the site. Drawing on this context, the proposals place an emphasis on the creation of open spaces and the preservation of landscape features to inform the character of the new neighbourhood, preserving existing habitats and delivering recreational opportunities throughout.

### 1. The Oak Woodland

The oaks are retained within the grassland setting, preserving this distinct landscape features.

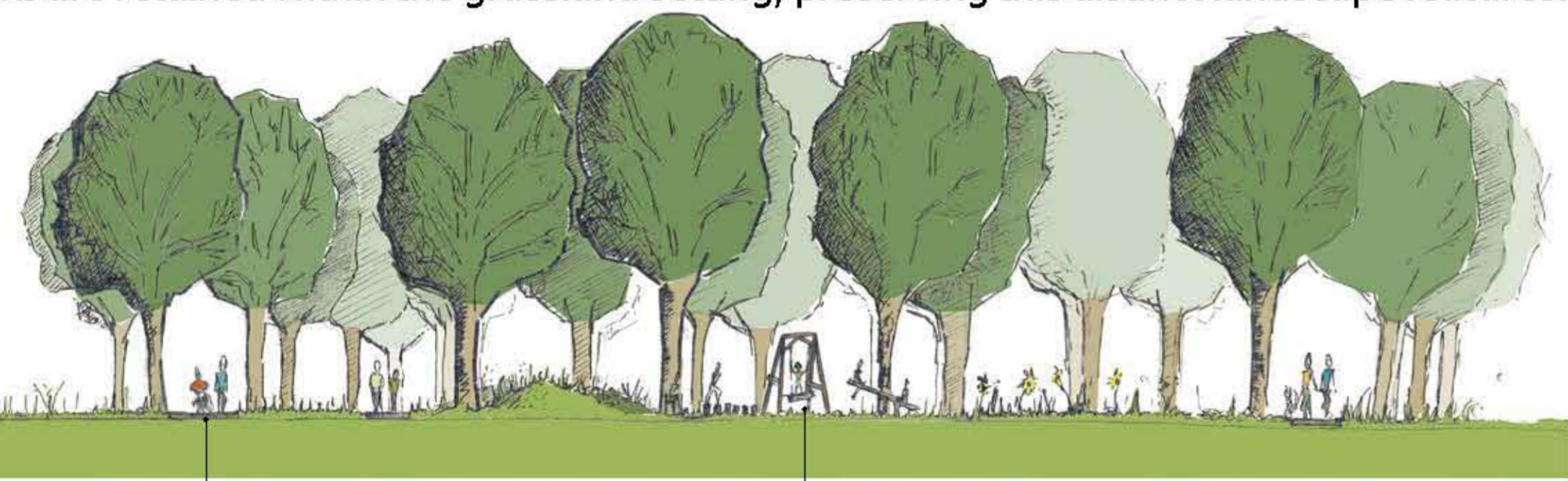

Differential mowing defines some paths but the majority of the landscape is left to nature.

Play opportunities set within a woodland setting



### 2. The Park

This linear open space provides a unique green link connecting the more southerly open spaces to the community facilities and the landscape to the north of the site.

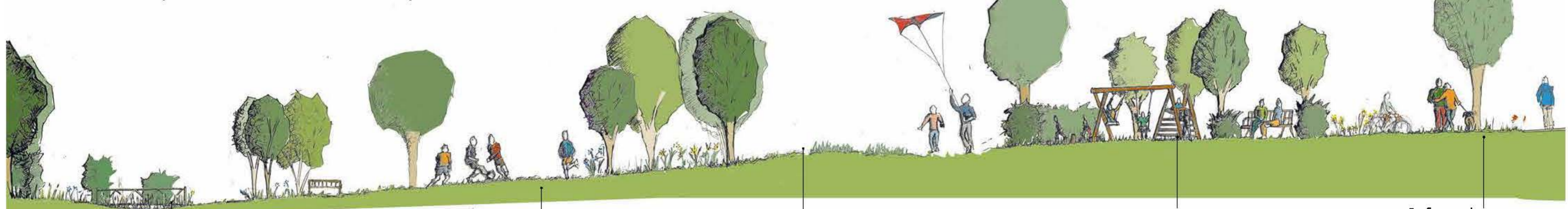

Potential opportunities to introduce wetland habitat species into the low lying sections of the open space

Informal play opportunities for local residents

Native meadow grasses and planting dispersed through out pastures

Formal play for local children providing community focus within a rich landscape setting

Informal recreational routes

### 3. The Wood

Woodland management will safeguard the 'wild' naturalistic qualities of this part of the site, whilst the introduction of paths and footpaths will open up recreational opportunities.

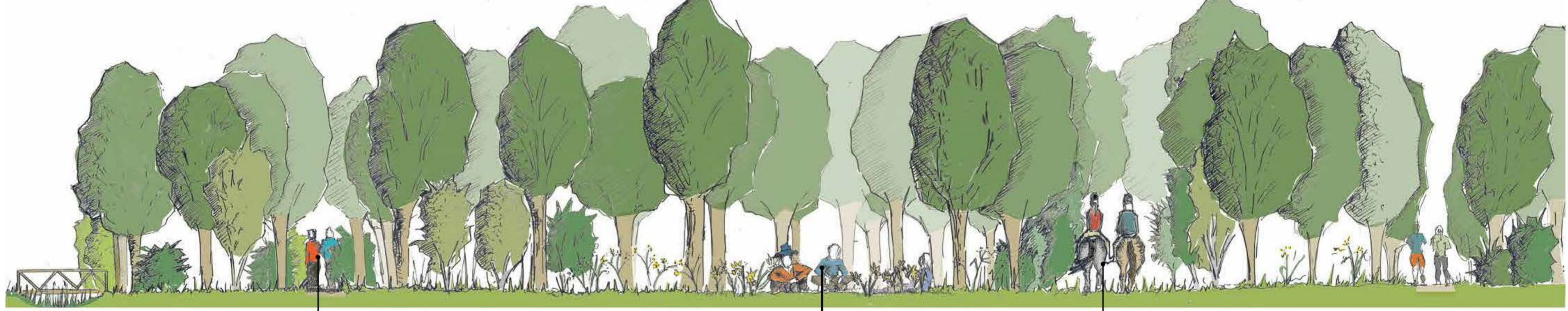

Informal paths picking up on natural movement patterns

The woodland floor beneath some naturally occurring breaks in the canopy should be cleared allowing woodland ground cover and seasonal planting to establish.

Opportunities to extend surrounding open space networks bringing added benefit to surrounding communities and entwining new and existing communities.